

Hoisting motors 4/16 poles LS FCPL

Primarily intended for hoisting and over head crane market, these two-speed brake motors have a new magnetic lamination customized for these applications. They give the motors a high performance of mechanical and electrical characteristics.

In the standard version , the range is manufactured with an aluminium alloy housing , cast iron flange and a failsafe **DC brake FCPL**, the brake torque is adjusted in the factory. The **FCPL** brake, whose all the components are manufactured by **MOTEURS PATAY**, has already proved to be robust and reliable in a very difficult environment typically building sites or quarries. In the standard version the coil voltage is **180 VDC**.

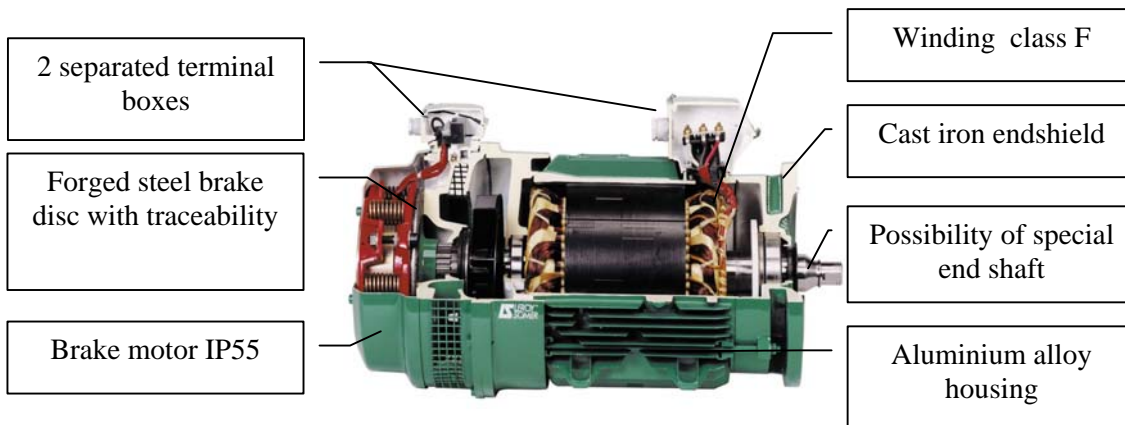

The available powers in 4 pole are **5.5 up to 30 kW**, in four frame sizes. The standard duty cycle is **S3 40% 240 starts per hour**.

Motor options : cast iron housing, thermal probes fitted in the winding (PTO, PTF, PTC), heaters, special end shafts.

Brake options : micro switch for brake release , air gap , brake wear detection , heaters, hand release lever, boost card , special voltage ..

For variable speed applications we can offer a complete range of brake motors.

P (kW)	Type	4 poles				16 poles				Brake
		Id(A)	In(A)	Cd (Nm)	Cn (Nm)	Id(A)	In(A)	Cd (Nm)	Cn (Nm)	Cf (Nm)
5.5/1.3	LS160M - FCPL54	53	12.6	70	37	16.8	10	65	37	75
7.5/1.9	LS160L - FCPL54	75	16.2	95	50	25	14	94	50	90
10/2.5	LS160L - FCPL54	109	21.8	135	67	33	18.4	130	67	110
13/3.1	LS180L - FCPL54	120	26.1	150	88	42	23.7	173	88	150
16/4	LS180L - FCPL54	146	31.4	188	108	52	28.7	209	108	180
18.5/4.6	LS200LT - FCPL54	184	37.4	213	184	64	34.5	227	124	220
22/5.5*	LS200L - FCPL60	220	42.2	276	148	67	41	295	148	260
30/7.5*	LS225MR - FCPL60	310	57	387	201	96	48.7	400	201	290

*these values are given as a guide ask factory to confirm them



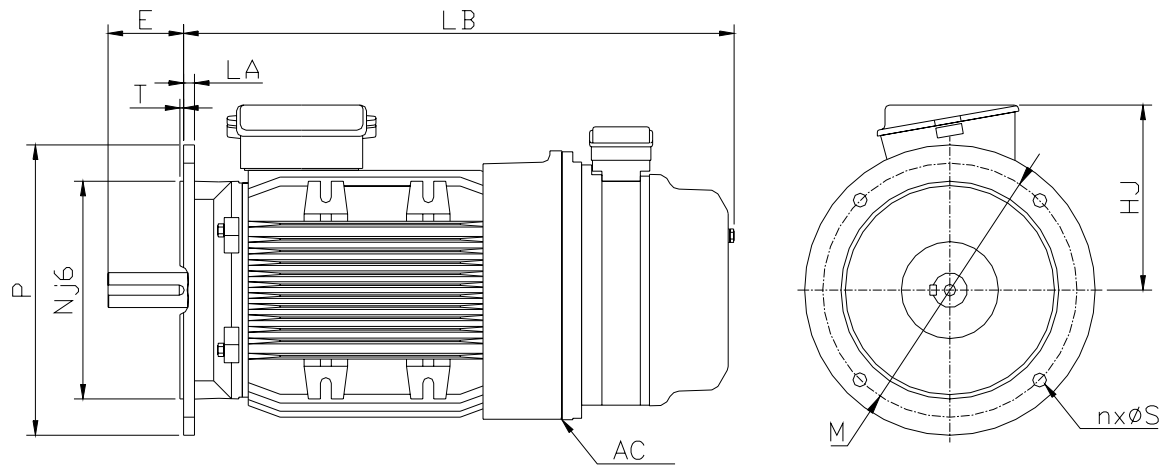

Type	Motor			Flange							
	LB	AC	HJ	Symbol	M	N	P	T	N	S	LA
LS160 M	668	345	235	FF300	300	250	350	5	4	18,5	14
LS160L	668	345	235	FF300	300	250	350	5	4	18,5	14
LS180L	795	384	255	FF300	300	250	350	5	4	18,5	14
LS200LT	785	384	255	FF350	350	300	400	5	4	18,5	15
LS200L	874	410	275	FF350	350	300	400	5	4	18,5	15
LS225MR	922	410	275	FF400	400	350	450	5	8	18.5	16

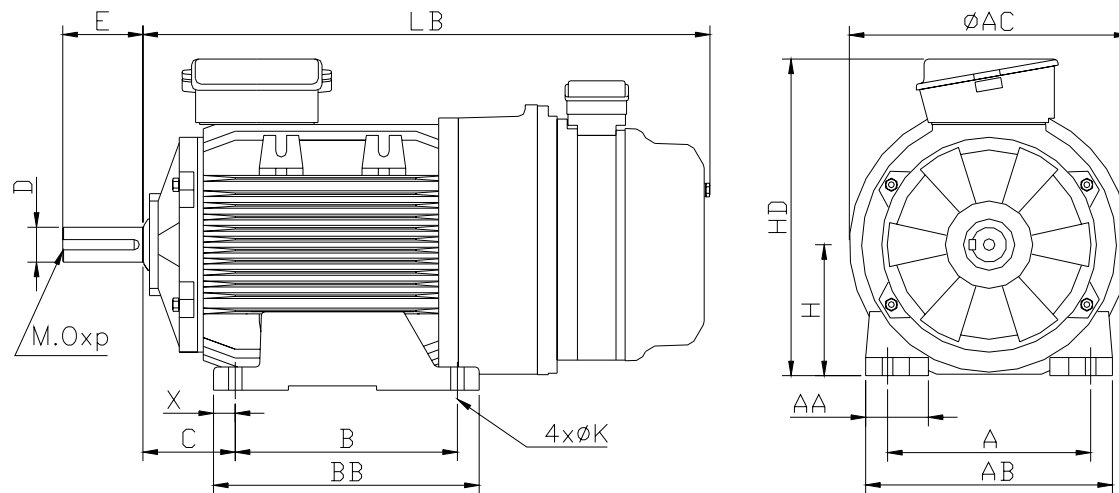

Type	Motor										End shaft					
	A	AB	B	BB	C	X	AA	K	H	AC	HD	LB	D	E	O	p
LS160 M	254	294	210	294	108	20	60	14,5	160	345	395	668	42 k6	110	16	36
LS160L	254	294	254	294	108	20	60	14,5	160	345	395	668	42 k6	110	16	36
LS180L	279	339	279	329	121	25	86	14,5	180	384	435	795	48 k6	110	16	36
LS200LT	318	378	305	365	133	30	108	18,5	200	384	455	785	55 m6	110	20	42
LS200L	318	388	305	375	133	35	103	18,5	200	410	475	874	55 m6	110	20	42
LS225MR	356	431	311	386	149	50	127	18,5	225	410	500	922	60 m6	140	20	42